

## PANELS

### Description

Panels are made of 2" x 2" x 10 GA welded wire mesh framed in 1 1/4" x 1 1/4" x 12GA structural angle with one or two welded 1/2"  $\varnothing$  reinforcement rods.

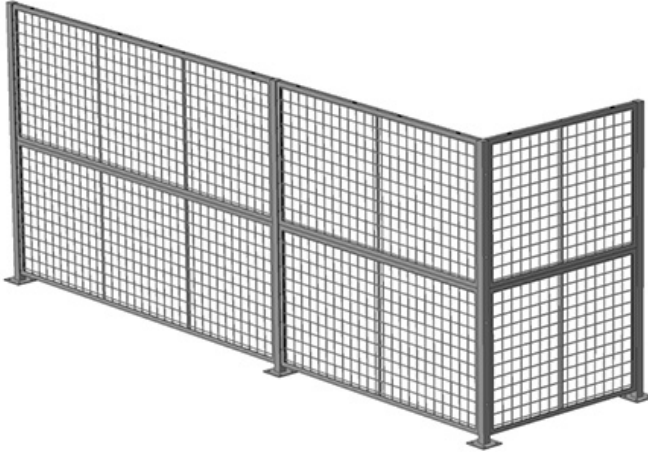

## PRODUCT INFORMATION

Panels are made of 2" x 2" x 10 GA welded wire mesh framed in 1 1/4" x 1 1/4" x 12 GA structural angle with one or two welded 1/2"  $\varnothing$  reinforcement rods.

### Specifications

**Need it fast?** This product is available for Accelerated Production. 2-week delivery on select components. See "Details" tab for a complete list of sizes.

*Accelerated Production orders are assembled using raw material that we keep in stock. This allow us to fast track your order through our abbreviated production process.*

#### SPECIFICATIONS

Panel Heights	1' to 5'
Panel Width	= (C/C Post Spacing) - 2"
Finish	Powder-coated
Mesh Size	2" x 2" x 10GA
Material Mesh	Steel Wire
Frame Material	Structural Angle 1 1/4" x 1 1/4" x 12GA
Stiffening Profile	1/2" $\varnothing$ Reinforcement rod

COLORS 

Cogan Grey



## DETAILS

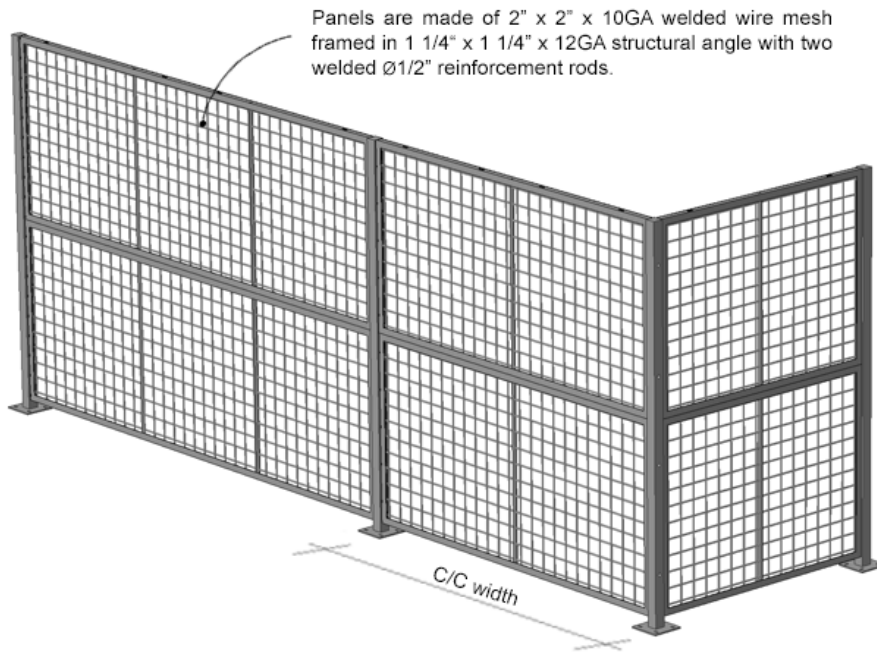

Panels are made of 2" x 2" x 10GA welded wire mesh framed in 1 1/4" x 1 1/4" x 12GA structural angle with two welded Ø1/2" reinforcement rods.

Panel dimensions are based on center-to-center post spacing. To calculate exact panel width apply the following:

$$\text{Exact panel width} = (\text{C/C dimension}) - 2"$$

### ACCELERATED PRODUCTION

*Sizes shown below are available for Accelerated Production.*

ITEM DESCRIPTION	ITEM #
Panel 2' W x 4'H (exact size 22" W x 47" H) - Framed 2" x 2" x 10GA welded wire mesh	P-P024
Panel 3' W x 4'H (exact size 34" W x 47" H) - Framed 2" x 2" x 10GA welded wire mesh	P-P034
Panel 4' W x 4'H (exact size 46" W x 47" H) - Framed 2" x 2" x 10GA welded wire mesh	P-P044
Panel 5' W x 4'H (exact size 58" W x 47" H) - Framed 2" x 2" x 10GA welded wire mesh	P-P054
Panel 6' W x 4'H (exact size 70" W x 47" H) - Framed 2" x 2" x 10GA welded wire mesh	P-P064
Panel 8' W x 4'H (exact size 94" W x 47" H) - Framed 2" x 2" x 10GA welded wire mesh	P-P084
Panel 10' W x 4'H (exact size 118" W x 47" H) - Framed 2" x 2" x 10GA welded wire mesh	P-P104
Adjustable Panel 2" to 12" x 8' H (exact size 2" to 12" x 94" H) - 16GA sheet metal	P-PFP1

## LAYOUT OPTIONS

Offering the finest support in the industry, our skilled engineers can help you configure your partition any way you want, building alongside existing structures or creating an enclosed room.

Please choose from one of the options below.

**OPTION 1**  
1- SIDED LAYOUT PARTITION

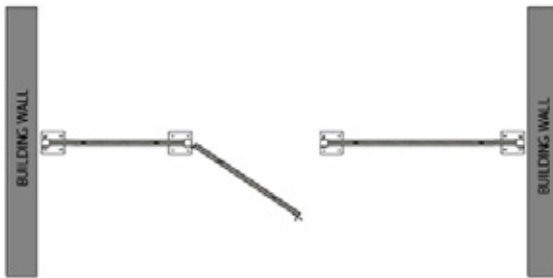

**OPTION 2**  
2- SIDED LAYOUT PARTITION

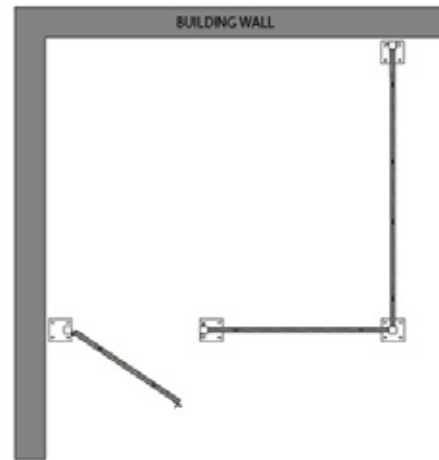

**OPTION 3**  
3- SIDED LAYOUT PARTITION

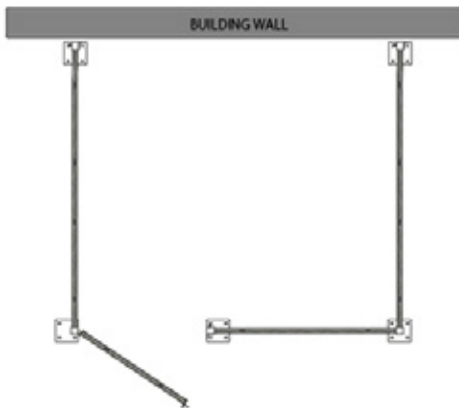

**OPTION 4**  
4- SIDED LAYOUT PARTITION

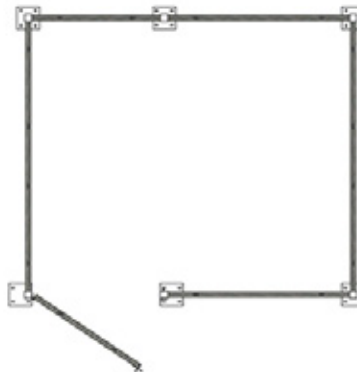

**OPTION 5**  
CUSTOM LAYOUT PARTITION

